

CALCULATION OF SOAKAWAY VOLUME

PRE DEVELOPMENT			POST DEVELOPMENT		
Site Area (m²)	%	3064	Site Area (m²)	%	3064
Roofed Area (m²)	0	0	Roofed Area (m²)	33	1016
Road Area (m²)	0	0	Road/Paved Area (m²)	37	1144
Landscaped (m²)	0	0	Landscaped (m²)	30	904
Unchanged Landscape	100	3064	Unchanged Landscape	0	0
Totals	100	3064	Totals	100	3064

Total hardened area : 2160 m²
Total Volume provided by JOJO Tanks at 60% Capacity : 6,0 m³
4 NO of Required JOJO Tanks : 10000 L
Total soakaway volume (1m² of storage per 40m² of hardened surfaces) : 53,40 m³ PROVIDE 54 m³

SITE CO-ORDINATES LATITUDE 29°34' S
LONGITUDE 31°07' E

SHEET 10 / 11 ONLINE-COPY
ETHEKWINI MUNICIPALITY
NORTH
NR22060007
APPLICATION NUMBER

BUILDING APPLICATION
APPROVED in terms Section 7 of the National Building
Regulations and Building Standards Act No. 103/1977
18 Aug 2023
LOCAL AUTHORITY
This plan is approved on the basis of the information shown herein.
Attention is drawn to the attached documentation & that this approval
shall lapse ONE year after the above approval date, unless the
erection of the building in terms of NBR Act 103/1977 is commenced.

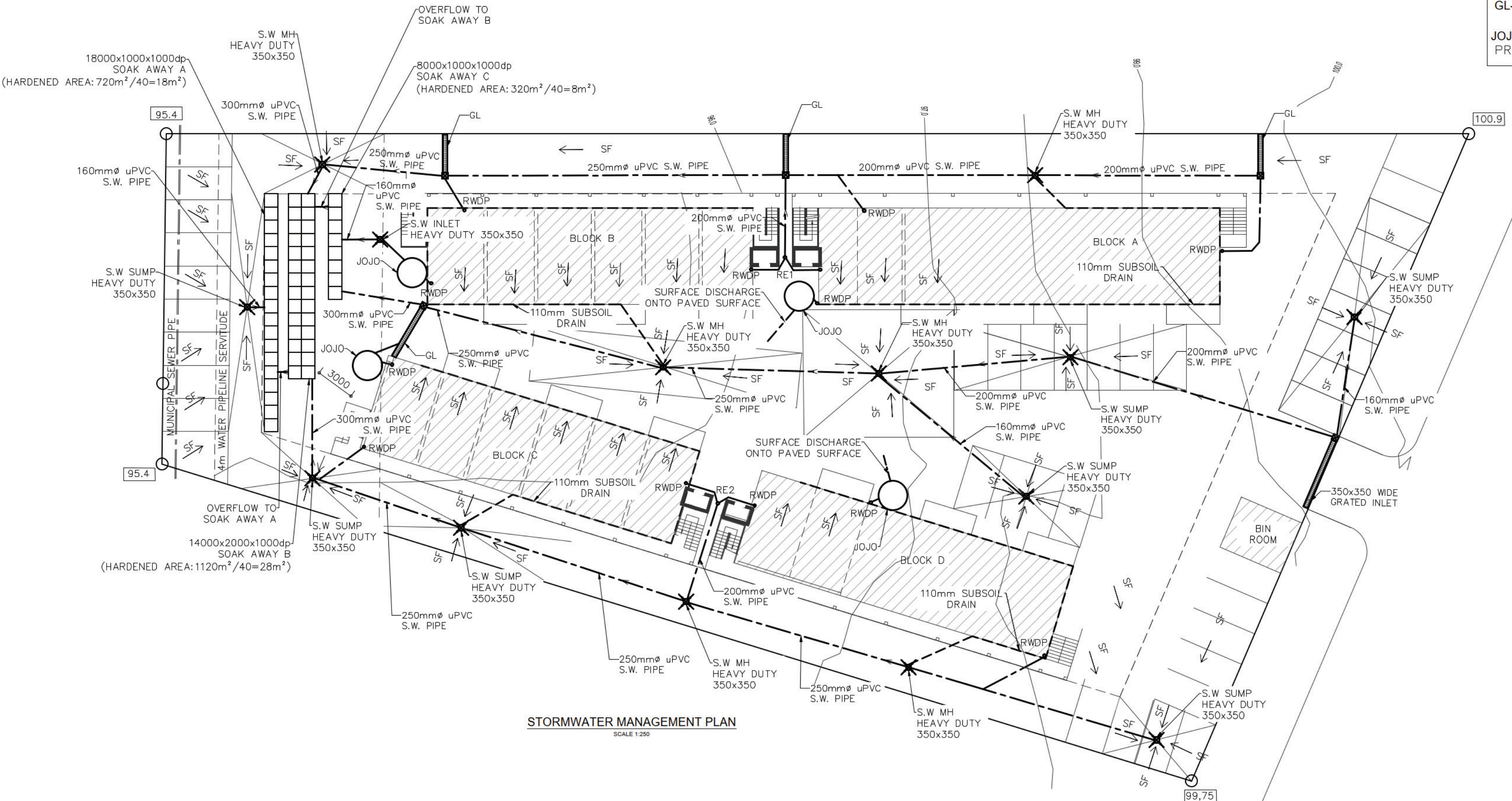

STORMWATER MANAGEMENT PLAN
SCALE 1:200

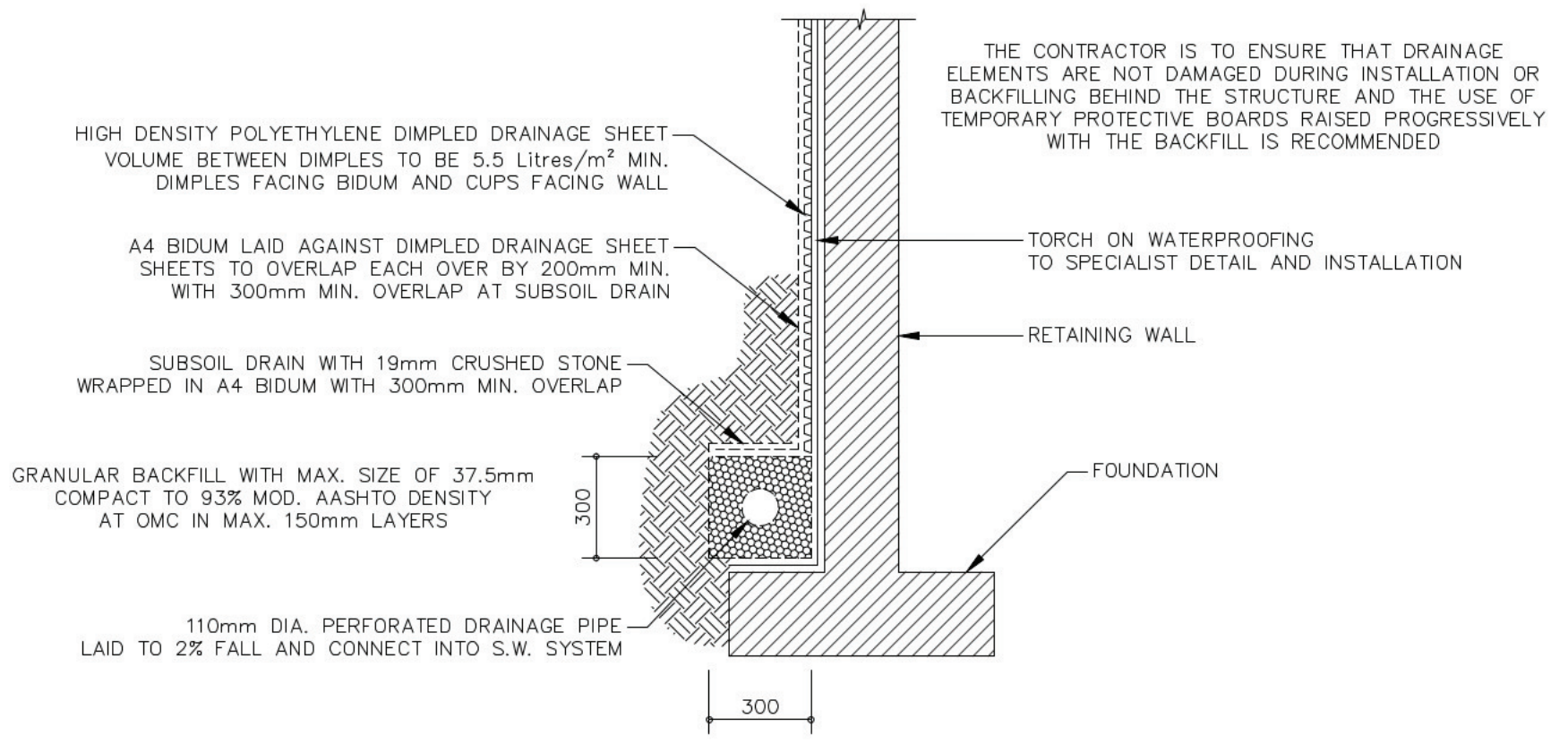

TYPICAL SECTION OF SUBSOIL DRAIN
SCALE 1:20

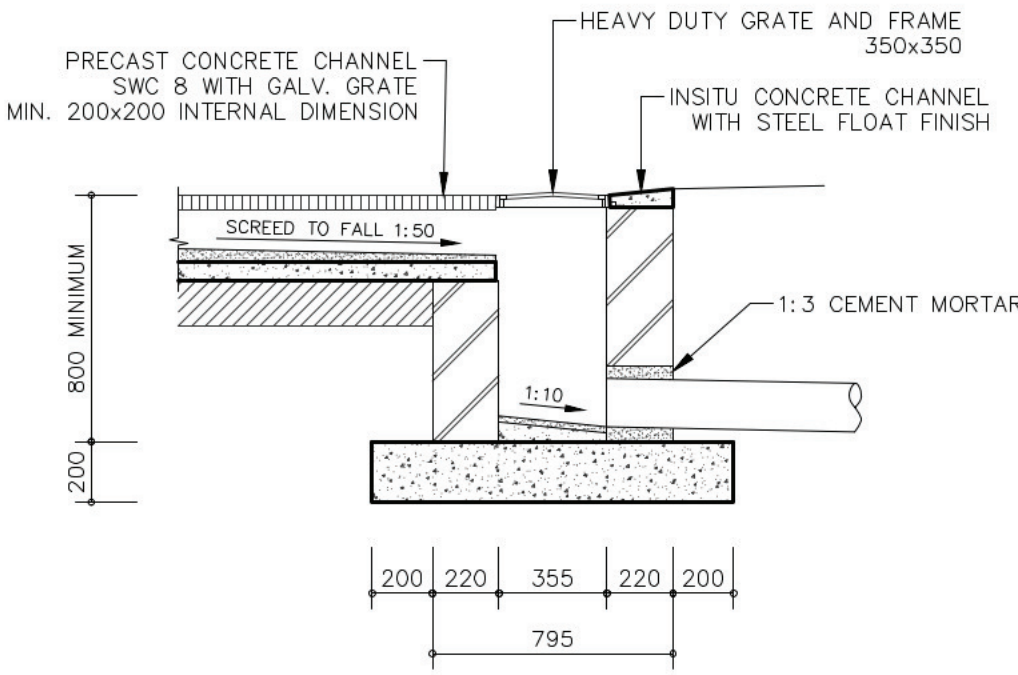

TYPICAL INLET SECTION
SCALE 1:25

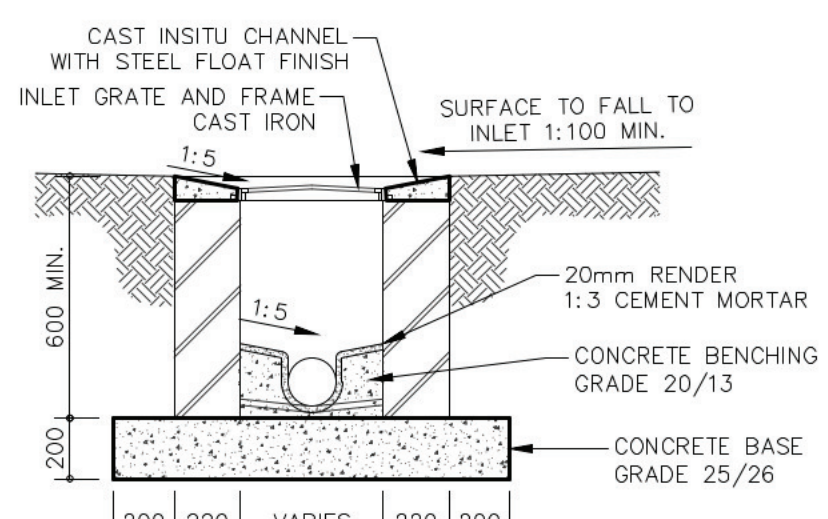

S.W. INLET - SECTION
SCALE 1:25

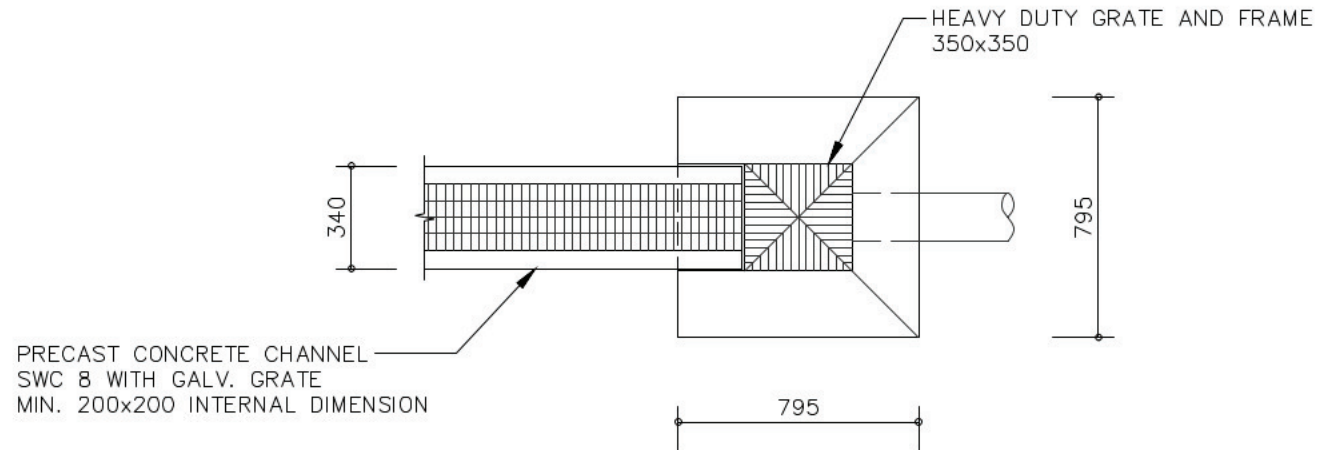

PLAN
CHANNEL INLET
SCALE 1:25

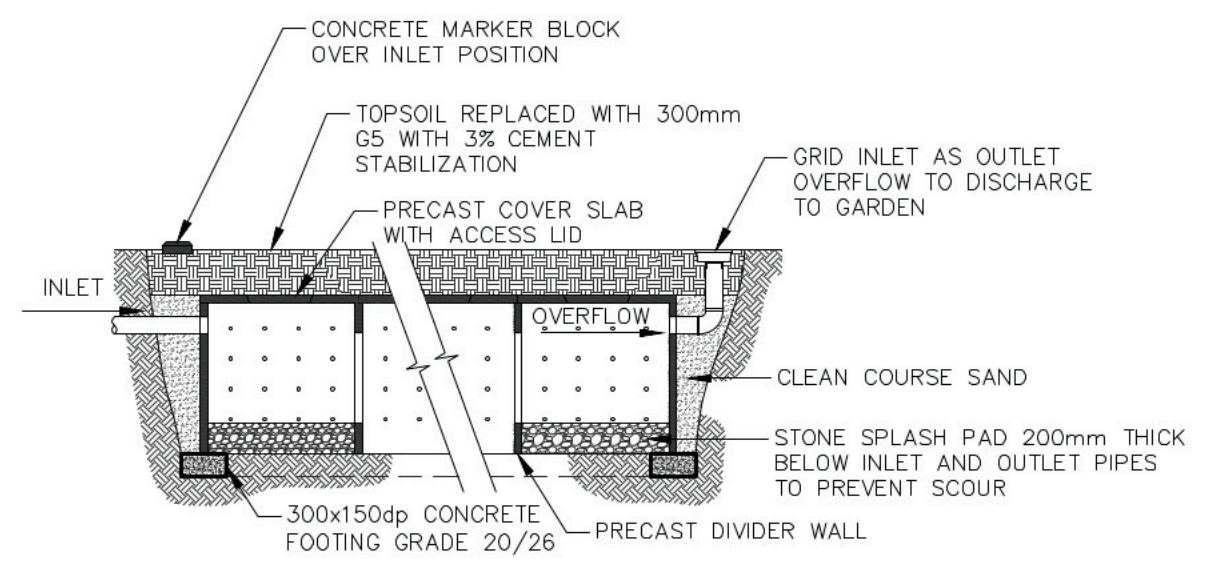

TYPICAL LONG SECTION
SCALE 1:50

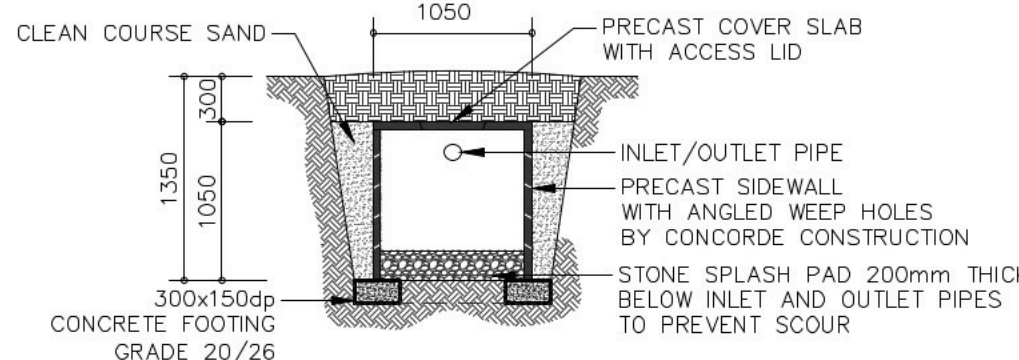

PRECAST INFILTRATOR CHAMBER BY
CONCORDE CONSTRUCTION-STORMWATER
SOAK AWAY
SCALE 1:50

ISSUED FOR SUBMISSION PURPOSES ONLY

MAINTENANCE:

- Silt Removal from culverts to be done on a regular basis to maintain optimum pipe capacity.
- Silt Removal from Attenuation Dams to be done on a regular basis to maintain storage capacity for Attenuation of Flood Peaks.
- Development to take place outside of the environmental buffer zones as per Environmental Recommendations (See EMP).

FUTURE MAINTENANCE:

- The engineer should be notified if there are any additions to the existing hardened area and attenuation points.
- Re-analyse if any a major changes occur in the channel cross section or/and additional controls (crossing) introduced into the system.
- Re-analyse flood lines if any further development occurs within the catchment.

DRAINAGE NOTES:

- All stormwater from roofs to discharge directly onto surfaces which drain to stormwater inlet manholes.
- All stormwater pipes to be class 51 u.o.n.
- Stormwater pipes laid beneath driveway to be class 34.
- All pipes to be laid at minimum fall of 1:80.
- All platforms to be shaped to fall to stormwater inlets, minimum fall 1:100.
- Platforms to be shaped such that overland flow overtops onto road.

PROJECT TITLE:
63 Plane Street Waterways Tongaat

DRAWING TITLE:
STORMWATER MANAGEMENT PLAN

BRAMIN
Consulting Engineers
Civil • Structural • Geotechnical

P O Box 60430
Phoenix
4080
Telephone: 031 502 1989
Fax: 086 571 4138

Suite 2, 1 Grove End Dr
Stammore, Phoenix
Cell: 083 777 2255
yashvir@bramin.co.za

DESIGNED	H.Govinder	JOB NUMBER	2181
DRAWN	H.Govinder	DRAWING NUMBER	S-01
CHECKED	Y.B.Maharaj	REVISION	D
SCALES	AS SHOWN		
DATE	21 JUNE 2023		